

---

**GEOGRAPHY**

**9696/33**

Paper 3 Advanced Human Options

**October/November 2017**

INSERT

**1 hour 30 minutes**

---

**READ THESE INSTRUCTIONS FIRST**

This Insert contains all the Figures and the Table referred to in the questions.



---

This document consists of **5** printed pages and **3** blank pages.

Fig. 1 for Question 1

Average number of calories per person per day from different foods in LEDCs, 1964–66 and 1997–99, and predicted for 2030

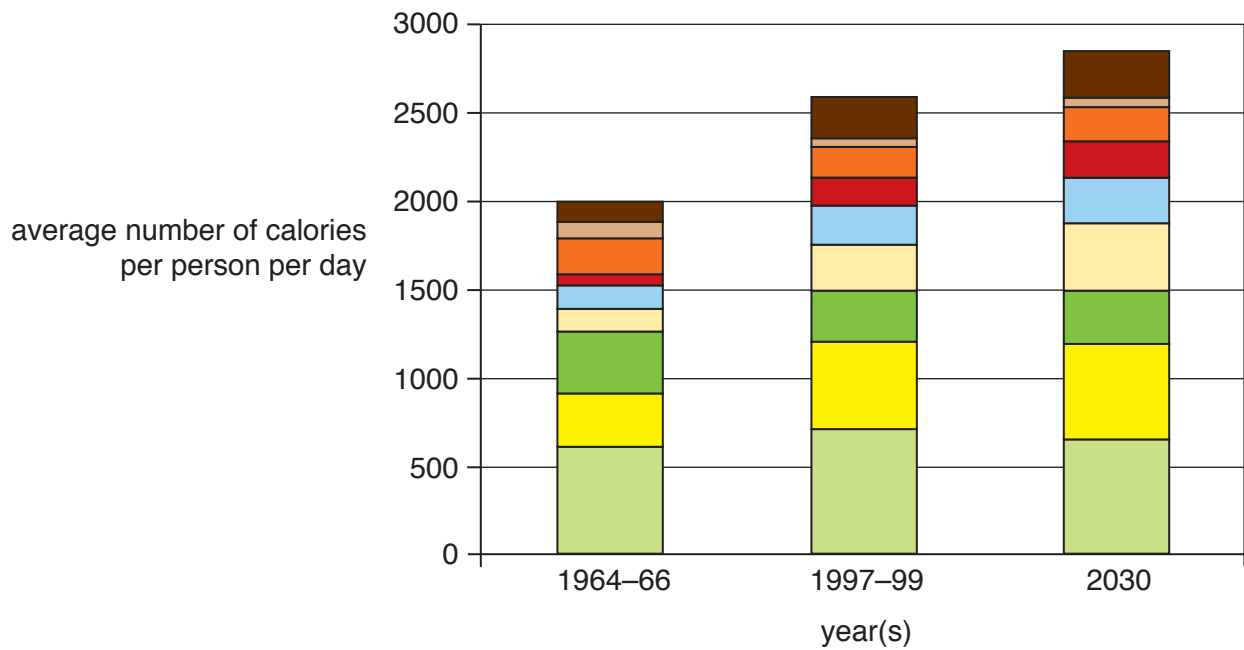

**Key**

- other
- pulses
- roots and tubers
- meat
- sugar
- vegetable oils
- other cereals
- wheat
- rice

Fig. 2 for Question 4

A solid waste management system

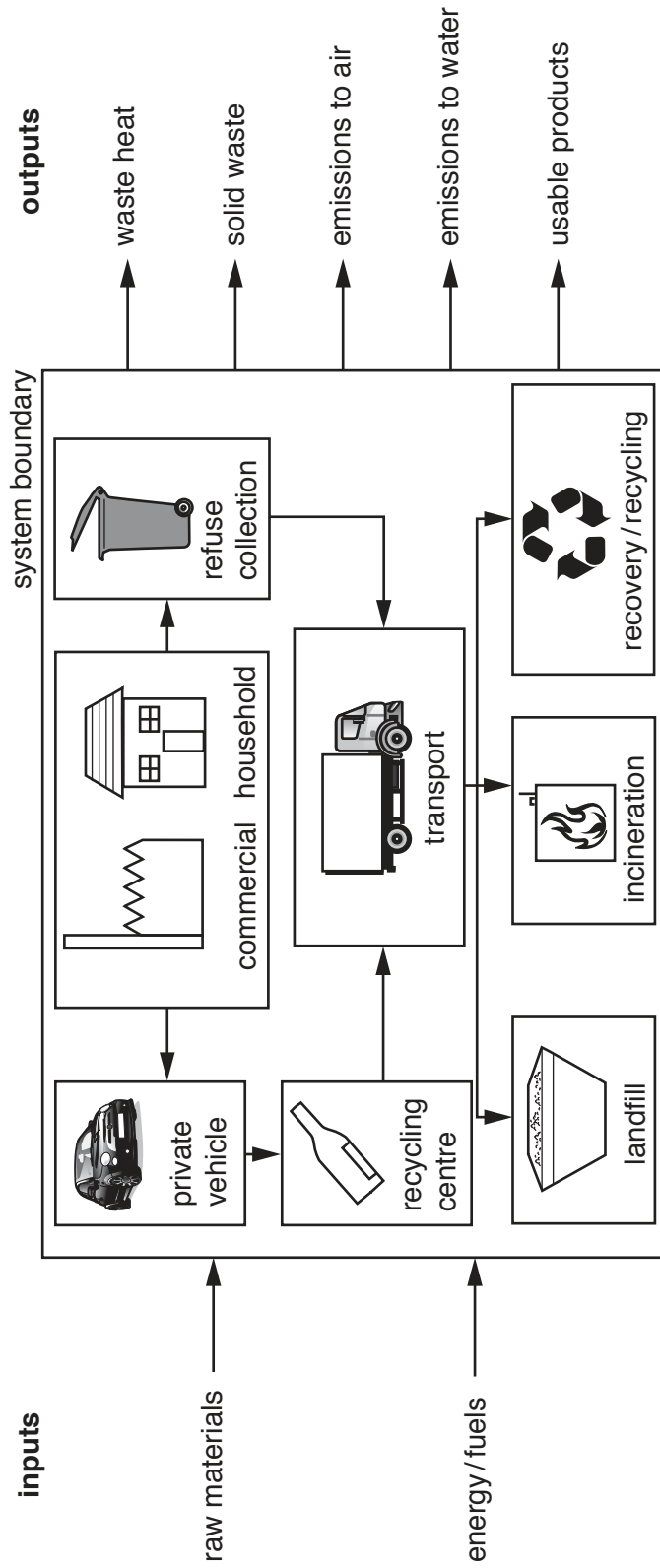

Table 1 for Question 6

Percentage of GDP from tourism for selected countries and one territory, 2014



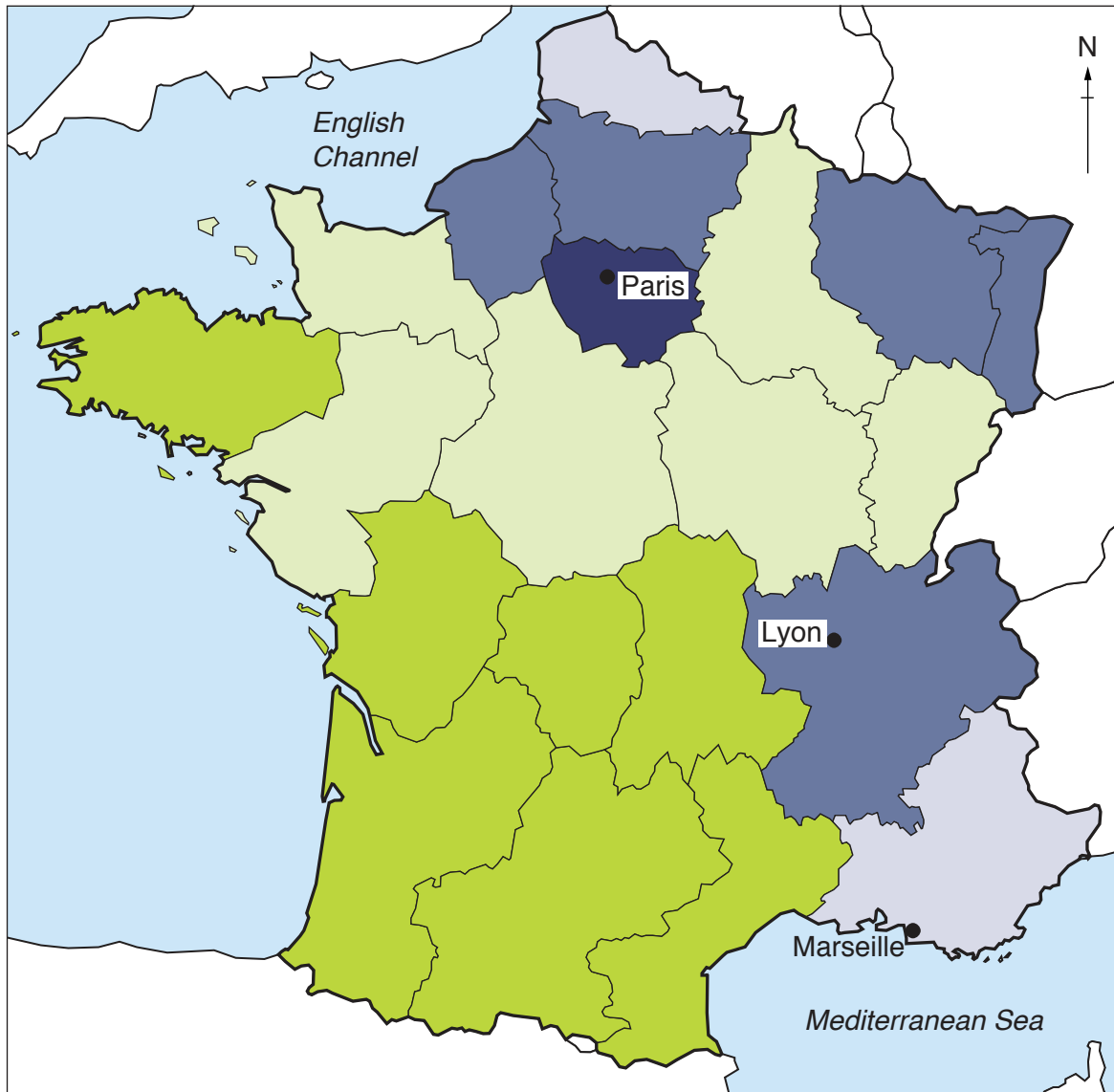

rank	country/territory, location	% GDP from tourism
1	Aruba, Caribbean	88.4
2	Macau, China, East Asia	87.6
3	British Virgin Islands, Caribbean	85.9
4	Maldives, Indian Ocean	78.1
5	Anguilla, Caribbean	61.2
6	Seychelles, Indian Ocean	56.9
7	Vanuatu, Asia Pacific	54.0
8=	Cape Verde, Atlantic Ocean Fiji, Asia Pacific	40.0
10	St Lucia, Caribbean	39.5
	<b>for comparison:</b>	
–	New Zealand, Asia Pacific	13.7
–	UK, Europe	10.5
–	USA, North America	8.0

Fig. 3 for Question 8

## Labour specialisation in France, an MEDC in Europe, 2008

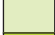

## Key

	specialised in services
	specialised in manufacturing
	balanced
	specialised in agriculture and manufacturing
	specialised in agriculture

0 100  
km





**BLANK PAGE**

---

Permission to reproduce items where third-party owned material protected by copyright is included has been sought and cleared where possible. Every reasonable effort has been made by the publisher (UCLES) to trace copyright holders, but if any items requiring clearance have unwittingly been included, the publisher will be pleased to make amends at the earliest possible opportunity.

To avoid the issue of disclosure of answer-related information to candidates, all copyright acknowledgements are reproduced online in the Cambridge International Examinations Copyright Acknowledgements Booklet. This is produced for each series of examinations and is freely available to download at [www.cie.org.uk](http://www.cie.org.uk) after the live examination series.

Cambridge International Examinations is part of the Cambridge Assessment Group. Cambridge Assessment is the brand name of University of Cambridge Local Examinations Syndicate (UCLES), which is itself a department of the University of Cambridge.